



UC8 ULTRA HIGH PURITY PRESSURE & VACUUM SWITCH SERIES

The UC8 Series incorporates Wasco's proprietary manufacturing method along with an Elgiloy® diaphragm. It provides ultra high purity and unmatched corrosion resistance. Its all-welded construction eliminates all leak paths.

This series is a perfect switch to handle corrosive media with high accuracy and tight tolerance.



UC8 HIGHLIGHTS

We've designed the UC8 Series for highly corrosive environments found in next-generation semiconductor processing equipment. The UC8 series is rated for more than 2,000,000 95B2 application cycles. The UC8 series has materials options available that meet or exceed SEMI F20 UHP requirements. All switches are helium leak tested to $\leq 1 \times 10^{-9}$ std cc/sec per SEMI F1.

TYPICAL APPLICATIONS

- Gas Boxes
- IGS Gas Panels
- Gas Distribution Systems
- Valve Manifold Boxes
- Etch & Deposition Systems

UC8 PERFORMANCE CHART

Model	Range of Activation Points*	Reset Band*	Activation Point Tolerance	Proof Pressure**	Burst Pressure**
UC8-A	50 to 1500 Torr Absolute Pressure	40 Torr +6% of activation point (typical)	± 15 Torr +2% of activation point (typical)	100 PSIG	1000 PSIG minimum
UC8-G	2 to 20 PSIG Gauge Pressure	1.0 PSIG +6% of activation point (typical)	± 1.0 PSI +2% of activation point (typical)	300 PSIG	1000 PSIG minimum

* Other ranges available

** Higher pressures available



MATERIAL SPECIFICATIONS

	Wetted Components
Process Port	316L SS* SEMI F20 UHP compliant
Diaphragm	Elgiloy®*
Interior Surface Finish	5 Ra

* Other materials available

TEMPERATURE SPECIFICATIONS

Operating Temperature	-20° to 60°C (-4° to 140°F)
Non-Operating Temperature	-40° to 100°C (-40° to 212°F)

TECHNICAL SPECIFICATIONS

Expected Lifetime	≥2,000,000 cycles 95B2 (depending on application)
Ingress Protection	IP67 (absolute configuration only)
Leak Rate	100% Helium Leak Tested to ≤ 1 x 10 ⁻⁹ std cc/sec

ELECTRICAL SPECIFICATIONS

UL 508	E489633		
	Max Amp Rating	Volts AC/DC	Contact Material
Electrical Rating	1	115/28	Gold
	3	250/28	Silver

UC8 DIMENSIONS

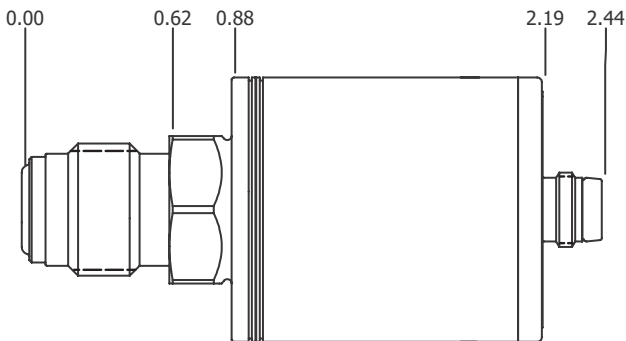

Typical UC8 with 1/4" Male Face Seal

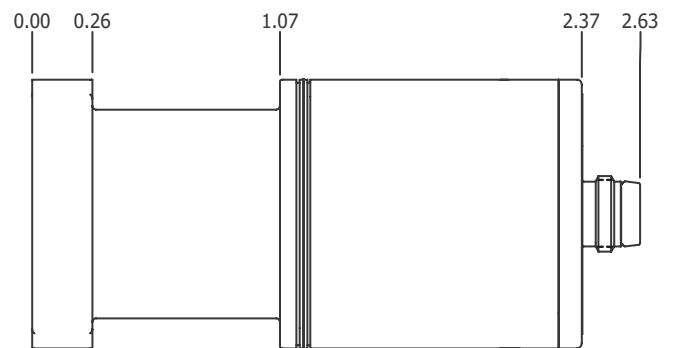

Typical UC8 with 1.125" C-Seal Surface Mount